

## FITTING INSTRUCTIONS VW-Beetle disc brake kit – 4-piston Front axle „internally ventilated“

Kerscher Tuning GmbH  
Eggenfeldener Str. 46a  
D-84326 Falkenberg

Telefon + 49 (0) 87 27 / 9 68 80  
Telefax + 49 (0) 87 27 / 96 88 29

01.02.2016 Br/Ke

### Contents:

- |   |   |
|---|---|
| <ul style="list-style-type: none"> <li>2 Brake discs (2) internally vented (or cross drilled and slotted)</li> <li>2 Brake calipers 4-piston (1)</li> <li>2 Adapter (21) (BB80212KER)</li> <li>1 Set Brake pads (7) (BZ80205KER)</li> <li>2 Set wheel bearings (3,4,5) (7580012KER)</li> <li>1 Accessory kit 6-parts (6)</li> </ul> | <ul style="list-style-type: none"> <li>4 Screws (23) M12x1,5x70 /12.9</li> <li>4 Screws (22) M10x1,5x35 /12.9</li> <li>May also be fitted:</li> <li>1 Master cylinder (BZ 52017 KER)</li> </ul> |
|---|---|



Our brake kits, 4-or 5-stud, can be fitted to all VW Beetles which were either fitted as standard with steering knuckles for disc brakes or have been converted at a later date.

NOTE: Diameter of the stub axle for the inner bearing 29mm necessary

('65-'67 models could have 27 mm – which are available from us, part-no:7580013KER)

**Maintenance and repair of brakes should be performed by qualified personnel only!!**



**Disassembly original brake:**

- Remove calipers (11), discs (13) with wheel bearings (15,14), cover plates (12) and stub axles (20).

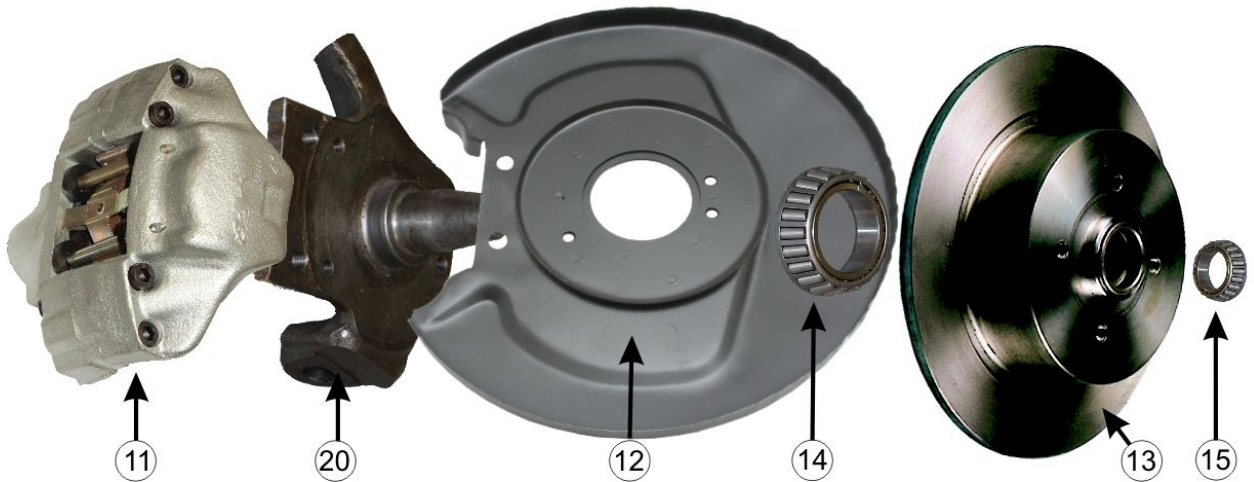

**Fitting Kerscher brake:**

- Before fitting our 4-piston brake you have to rework the knuckles according to attachment 1. We can do this for you, if you send us your knuckles.
- Mount reworked knuckles (20).
- Grease inner and outer wheel bearings (3) with usual bearing grease
- Press the wheel bearing shell (4) for the inner and outer wheel bearing into the brake discs (2) by using suitable tools. Insert the inner wheel bearing (3) and mount seal (5) with suitable tool.
- Push the pre-assembled brake disc onto the kingpin. Insert the outer wheel bearing (3) and fix it with pressure disc (16) and lock nut (17). Make sure that the pressure disc does not tilt. Adjust wheel play and tighten screw (18). Tightening torque 13Nm. Mount wheel cap (19).
- NOTE: you need different grease caps when you mount brake discs PCD 100/4 – available from us, part-no: 7K00012POR.

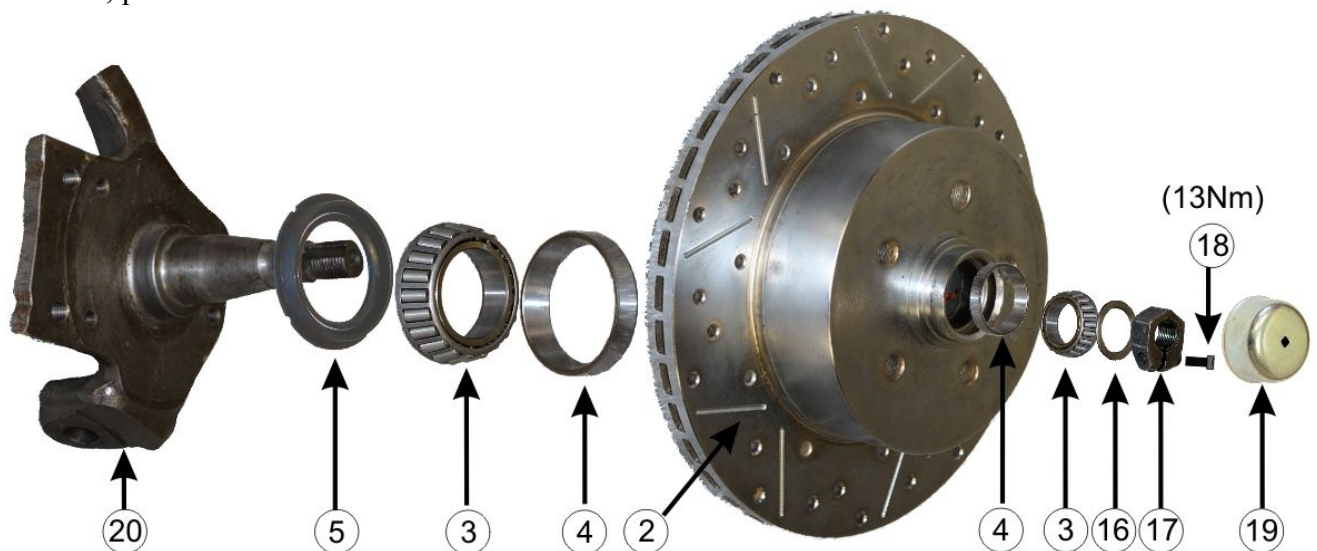

- Screw delivered adapter (21) with screws M10x35mm (22) together with knuckle (21). Tightening torque 60Nm.
- Push brake caliper (1) over the brake disc and screw together with screws M12x70mm (23). Tightening torque 60Nm.
- Mount brake pads (7) with accessory kit (6).
- Bleed the complete brake system.

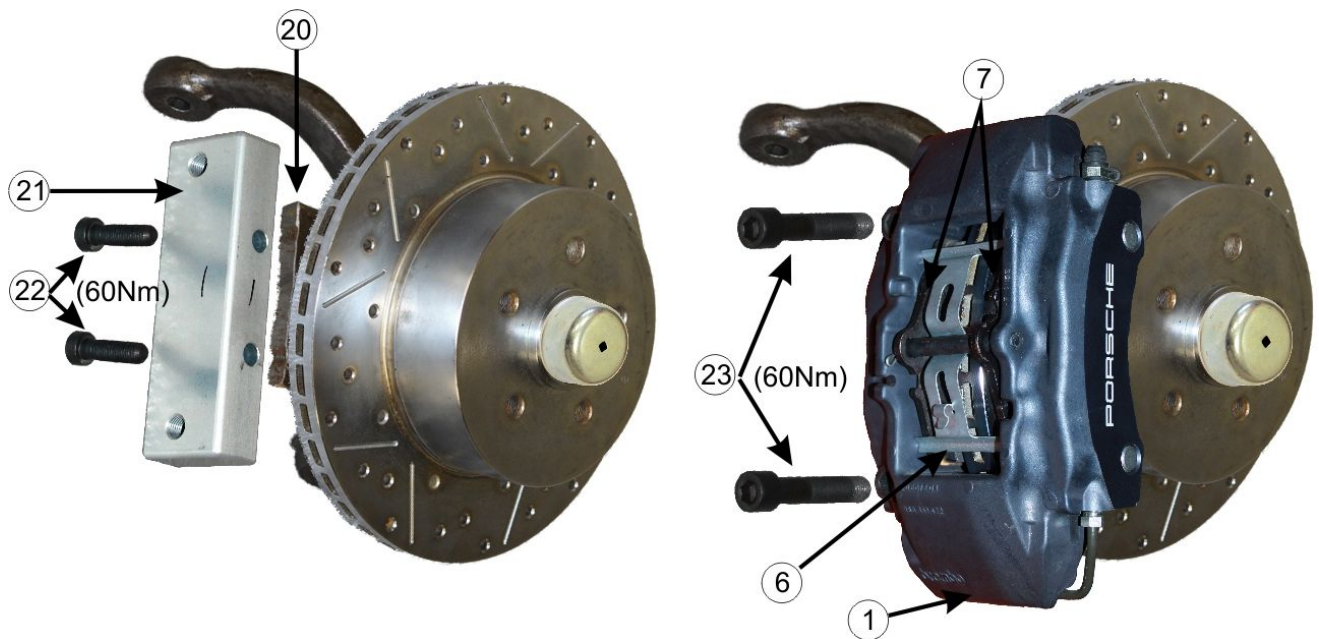

**Check before test drive:**

- recheck the tightness of all mounted parts – also check leaktightness.
- function control and test on brake test stand.

**How to run-in the new brake pads / brake discs**

- You should run-in new brake pads ca.50km – then they reach their full effect.
- Run-in new brake pads carefully by braking a few times with little pedal force from 80km/h to 40km/h. Let brake cool down a bit in between.
- A abrupt braking only in emergency case.





**Attachment 1**  
**How to rework knuckle VW-Beetle  
for 4-piston brake caliper**

1. enlarge contact surface for brake caliper towards kingpin by milling out.  
(final dimension: 35mm from center of original thread)

22,0mm = 0,866 inch  
31,0mm = 1,220 inch  
35,0mm = 1,377 inch  
56,0mm = 2,204 inch

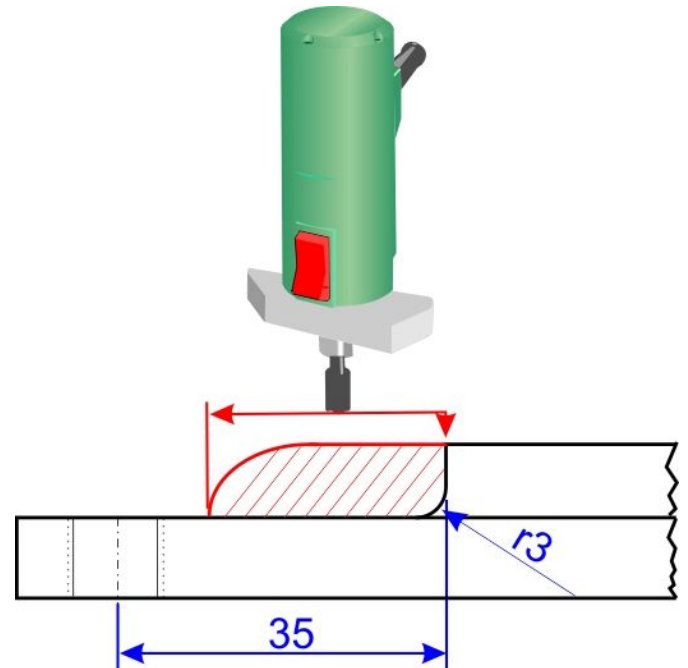

2. Cut in thread M10x1,5 (2x)

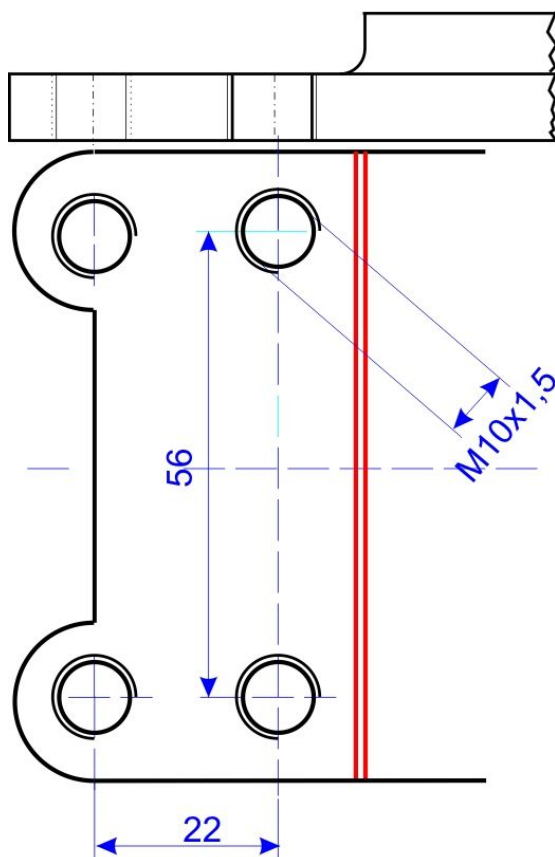

3. Cut knuckle

